

The OP80S is a stackable 6 port/2 way change over valve designed to be used when extra circuits are to be operated from one control lever on machines such as fork lift trucks, agricultural front-end loader, telescopic handlers, and in transmission circuits.

OVERALL SPECIFICATIONS

- Maximum working pressure.....250 bar (3500 psi)
- Maximum Casting shock pressure.....840 bar (12,000 psi)
- Rated flow 3/8"bspp.....40 ltrs/min
- Rated flow 1/2"bspp.....60 ltrs/min

MATERIAL SPECIFICATIONS BODY

- BodyHigh tensile strength cast iron
- Spools.....Hardened steel chrome plated spools
- Seals.....Buna - N

STANDARD FEATURES

- 6-way 2-position circuit
- 3/8 or 1/2" bspt Ports
- 12 or 24 volt solenoid operated

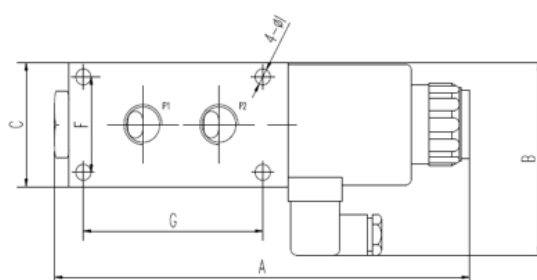

	A	B	C	D	E	F	G	H	I	J
OP80S-3/8" BSPP	175.2	84	52	36	57.5	38	42	6.4	6	52
OP80S-1/2" BSPP	229	100.6	65	46	70	50	99	8	8.4	65

Part Number	Description	List Price
08103812	OP80S-3/8" BSPP 12 VOLT DC	250
08103824	OP80S-3/8" BSPP 24 VOLT DC	250
08101212	OP80S-1/2" BSPP 12 VOLT DC	310
08101224	OP80S-1/2" BSPP 24 VOLT DC	310