

The OP20 Directional Valve Series provides a compact range of manually operated directional valves for low flow applications. The physical size of OP20 valves is ideally suited for mounting on small and large machines and has a higher flow range than other valves of this size. Like all Oilpath DCV's the handle assembly is fully enclosed to reduce the likelihood of corrosion affecting the handle mechanism. The handle bracket and spring end cover are made from glass filled nylon that has better impact and wear properties than aluminium. The OP20 has individual lift drop checks in the end of each spool giving the valve a unique feature in having a checks to maintain lift individually for all appropriate valve functions. (e.g. a 5 spool double acting valve has 10 lift drop checks). Closed centre and power beyond are also available with the use of plugs.

OVERALL SPECIFICATIONS

- Number of Spools.....1 to 5
- Maximum working pressure.....280 bar (4000 psi)
- Rated flow.....118 ltrs/min (10 Imp. gpm)
- MATERIAL SPECIFICATIONS Body.....High tensile strength Australian cast iron
- Spools.....Hardened steel
- Seals.....Buna - N

STANDARD FEATURES

- Series Parallel circuit
- Integral HydraForce direct acting relief valve, adjustable [Set at 175 bar (2530 psi)]
- Optional side/top inlet and outlet ports
- 7/8" UN O-Ring inlet, outlet and work ports (optional threads include ¾ bspp & 1-1/16" un)
- Open or closed centre positions, 3-way or 4-way operation, motor spool and other spool options
- Individual steel ball non-return checks located in spools

OPTIONS

- Micro switch actuation on spool shift
- 2 and 3 position detent & spring centred detent
- Pneumatic spool actuation
- Closed circuit & power beyond
- Cable control

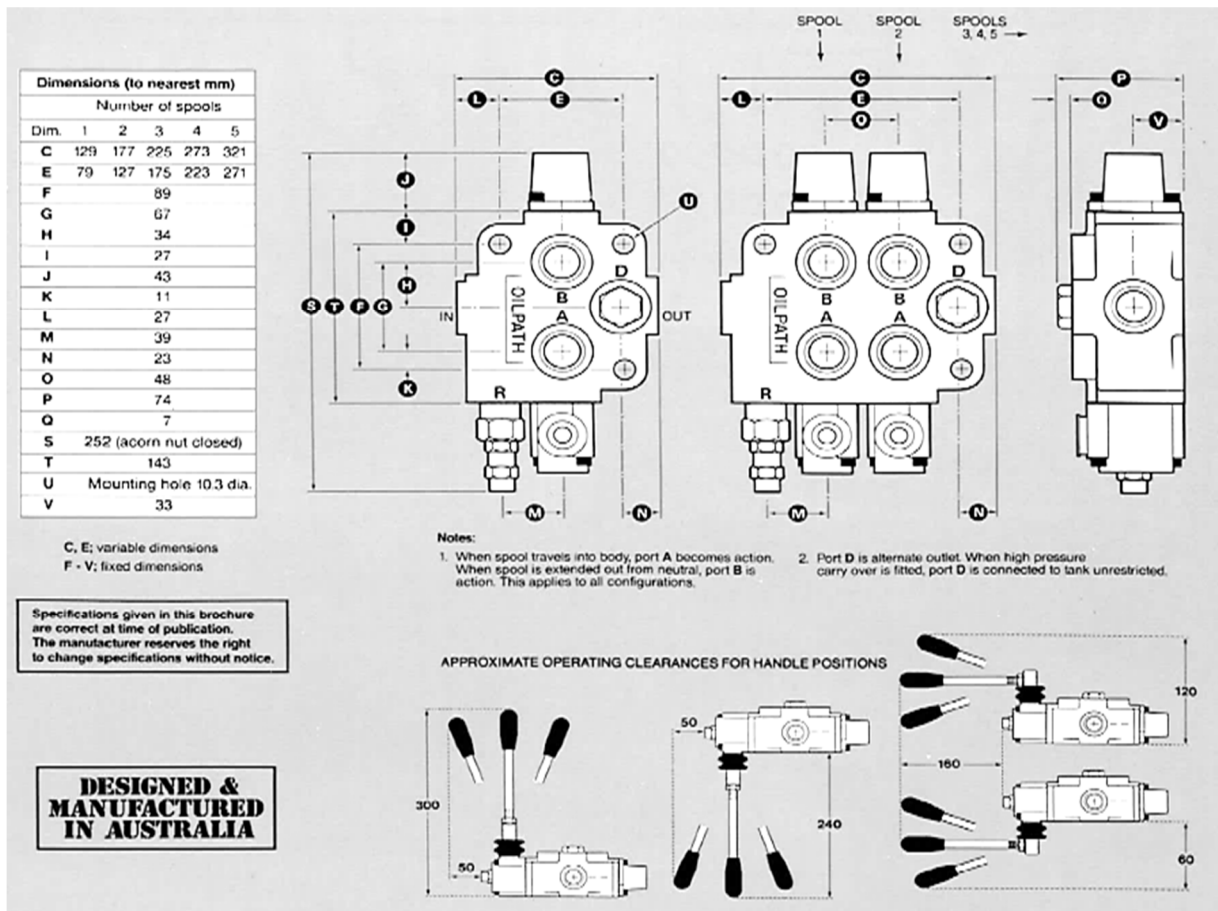
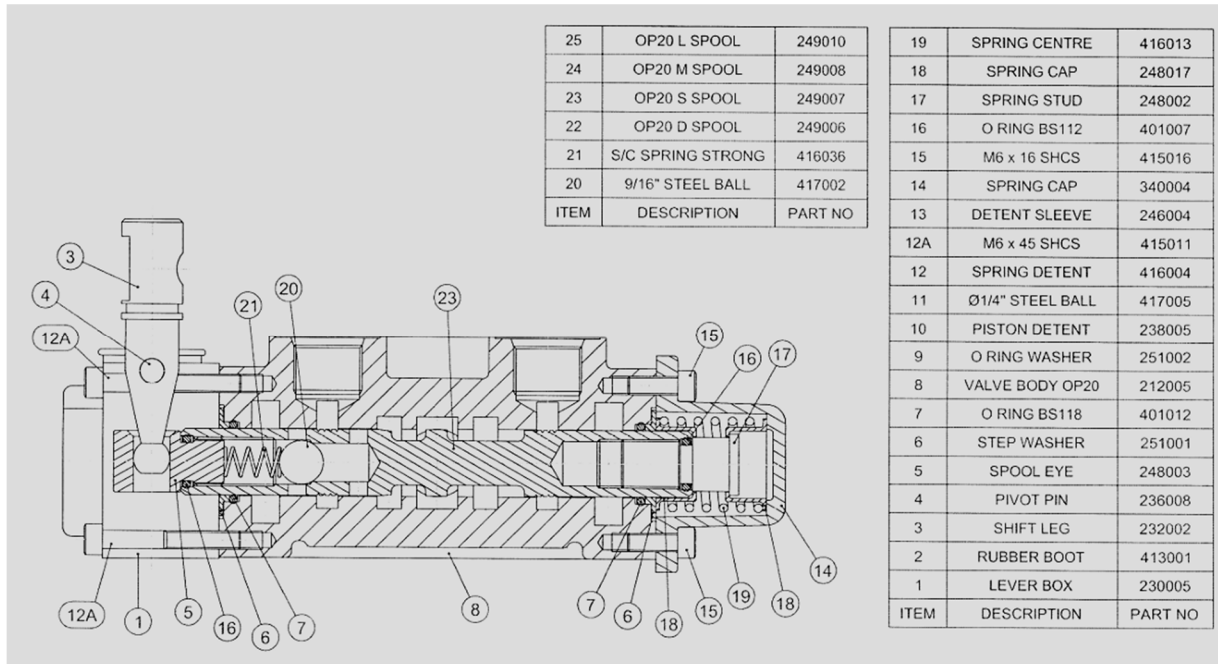

Spool Type		Relief Setting	Options			
D	Double Acting		PB	High Pressure carry over	D	Three Position Detent
S	Single Acting		CC	Closed Centre	W	Air Control OP106
M	Motor Control		NR	No Relief	BF	Bottom face Outlet
K	Flow Control not pressure compensated		SCDA	Spring centred detent to "A"	SCDB	Spring centred detent to "B"
L	Double Acting Spool with no load checks		H	Handle on auxiliary control e.g. W1H1	HI FLOW	Hi Flow, increasing flow to120 l/min with 3/4"bspp or 1-1/16" un R2 relief
P	Pressure Compensated Flow Control		OP106S	Electric over air solenoid control state voltage required e.g. OP106S24V	MU	special plating and hardware for mine or marine use
Please Note: Maximum tank pressure is 250 psi on OP20 valves			RESTA	Restricted detent to "A" port	RESTB	Restricted detent to "B" port

OP20D 2000 PB
 OP20DDS 2500 W123H123
 OP20DSSS 1500 SCDB1
 OP20DDDDM 3500 SCDB23

Single Double acting spool 2000psi relief high pressure carry over

Triple 1st & 2nd spool double acting 3rd spool single acting 2500 psi relief with air and handle operation on all spools

Four spool valve 1st spool double acting spools 2nd 3rd & 4th spools single acting 1500 psi relief with spring centred detent to "B" detent on 1st spool

Five spool with double acting spools on 1,2,3, & 4 and motor spool on 5th spool 3500 psi relief spring with 24volt solenoid unloading relief valve

OP20 Directional Control Valve Pricing

Part Number	Description	List Price Base Valve	15% discount for No Options (Double Acting) List Price
0201xxxx	Single Spool Valve	449	390
0202xxxx	Two Spool Valve	661	575
0203xxxx	Triple Spool Valve	891	775
0204xxxx	Four Spool Valve	1141	992
0205xxxx	Five Spool Valve	1408	1224

OP20 Options Pricing

OPTIONS for OP20	Part Number	Description	List Price
P	-	Priority Flow Control Spool Factory fit only, lead time applies	346
M	-	Motor Spool, penalty per each when factory fitted	0
K	-	Spool includes friction detent and can only be factory fitted	95
L	-	L Spool is D/A and has no load checks, used for high flows applications	37
D1	507007	Detent per spool, (3 position) factory fit, # indicates position	44
SCDB	509020	Spring Centred Detent with det. Acting on B port is pressurised	133
SCDA	509007	Spring Centred Detent with det. acting on A port is pressurised	133
PB	511003	High Pressure Carry over plug for power beyond "Hi-Cap"	25
PBH	511005	High Pressure Carry over plug 1- 1/16" UNF Hi - Flow	60
CC	511047	Closed Centre Plug (Plug A) part of kit for closed centre	24
NR	511002	Pressure Relief Plug (Plug B) part of kit for closed centre	23
LW	-	Pressure Relief Lock Wire (lead seal)	25
BF	-	Bottom Face Outlet available only as special build from factory	POA